

① **BEDROOM 6**
13'-6" X 11'-10"
10' CEILING

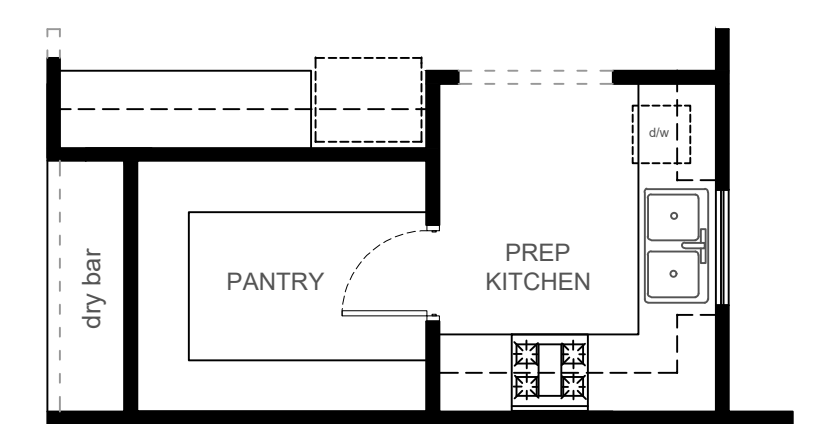

② **PREP KITCHEN**
9'-0" X 8'-4"
10' CEILING

ZYRA

FIRST FLOOR 3,122 S.F.

SECOND FLOOR 1,142 S.F.

TOTAL LIVING (A/C) AREA 4,263 S.F.

OPTIONS

BEDROOM 6 (+ BATH) 117 S.F.

BEDROOM 5 (+ BATH) 363 S.F.

MEDIA ROOM 272 S.F.

GARAGE 775 S.F.

PORCH 54 S.F.

COVERED PATIO 372 S.F.

ZYRA

| | |
|--------------------------------|-------------------|
| FIRST FLOOR | 3,067 S.F. |
| SECOND FLOOR | 1,125 S.F. |
| TOTAL LIVING (A/C) AREA | 4,192 S.F. |

OPTIONS

| | |
|--------------------|----------|
| BEDROOM 6 (+ BATH) | 117 S.F. |
| BEDROOM 5 (+ BATH) | 339 S.F. |
| MEDIA ROOM | 263 S.F. |
| GARAGE | 769 S.F. |
| PORCH | 38 S.F. |
| COVERED PATIO | 382 S.F. |

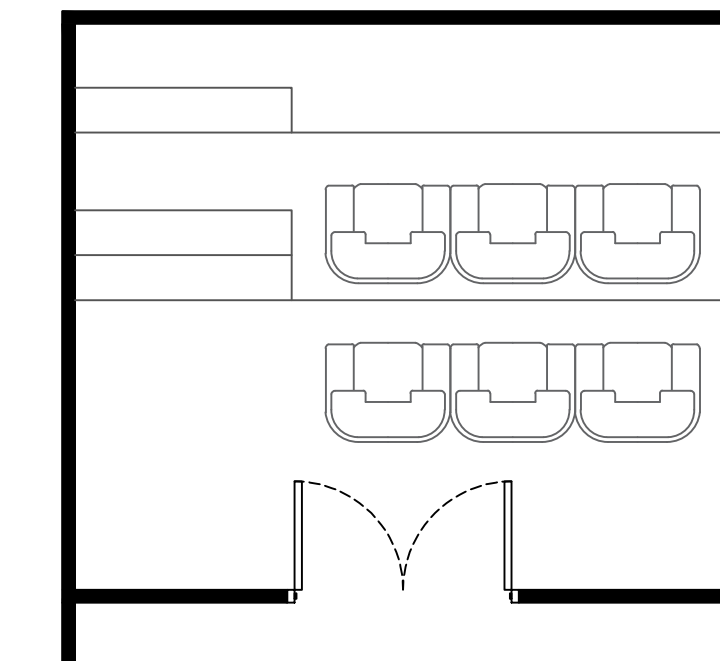

③ MEDIA ROOM
16'-7" X 15'-2"
9' CEILING

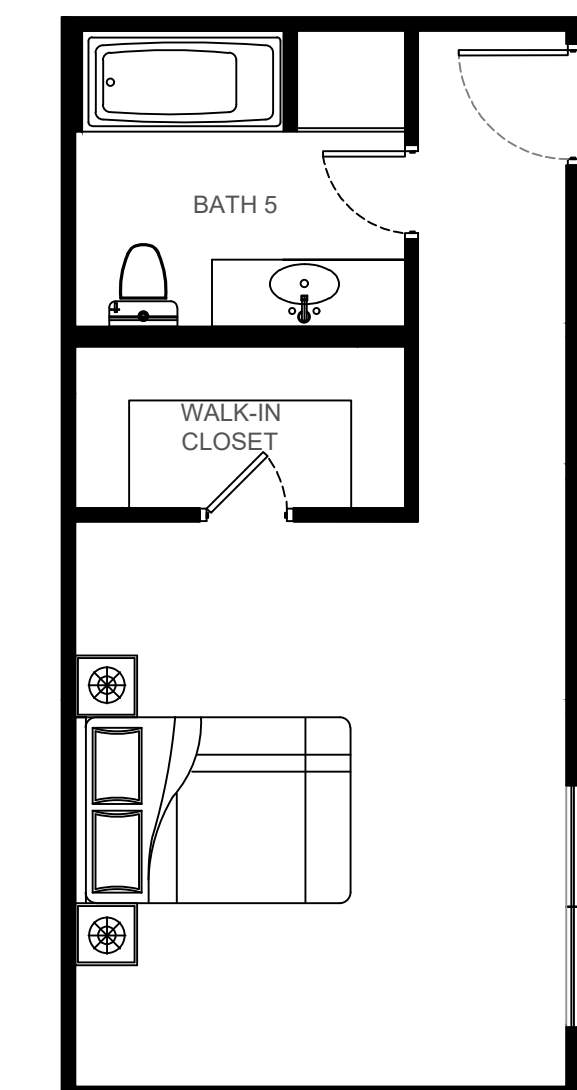

④ BEDROOM 5 (+ BATH 5)
14'-8" X 14'-0"
9' CEILING